

Tipo-Type	DIMENSIONI - DIMENSION [mm]												Peso ^(a) Weight kg.
	Pompa - Pump									Albero - Shaft			
	DNa	DNm	A	B	C	D	E	F	G	d	u	t	
40 - 4 50 - 4	65	50	281	217	704	309	200	240	240	24	8	27	72
40 - 5 50 - 5	65	50	327	263	750	355	200	240	240	24	8	27	78.5
40 - 6 50 - 6	65	50	373	309	796	401	200	240	240	24	8	27	85
40 - 7 50 - 7	65	50	419	355	842	447	200	240	240	24	8	27	91.5
40 - 8 50 - 8	65	50	465	401	888	493	200	240	240	28	8	31	98
40 - 9 50 - 9	65	50	511	447	934	539	200	240	240	28	8	31	105
40 - 10 50 - 10	65	50	557	493	980	585	200	240	240	28	8	31	111

FLANGIA ASP. (PN 16 EN 1092-2) SUCTION FLANGE						FLANGIA PREM. (PN 40 EN 1092-2) DISCHARGE FLANGE					
DNa	DE	CF	DR	Fori - Holes		DNm	DE	CF	DR	Fori - Holes	
				zf	if					zf	if
65	185	145	120	4	18	50	165	125	104	4	18

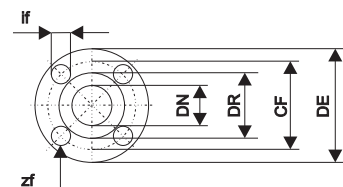

Quote e pesi suscettibili di variazione.
Dimensions and weights are subject to variations.

^(a) Lunghezza del giunto spaziatore.
Spacer coupling's length.